

Specifications:  
 Operating Voltage:250V AC/DC  
 Current Rating:3A AC/DC  
 Withstand Voltage:1000V AC/Minute  
 Contact Resistance:≤10mΩ  
 Insulation resistance:≥1000mΩ  
 Operating Temperature:-25℃~+85℃  
 Material:PA66 UL94V-0  
 PIN Brass Tin-plated

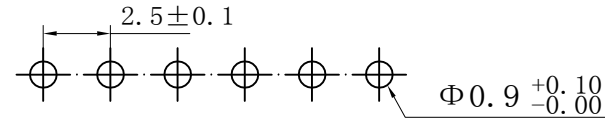
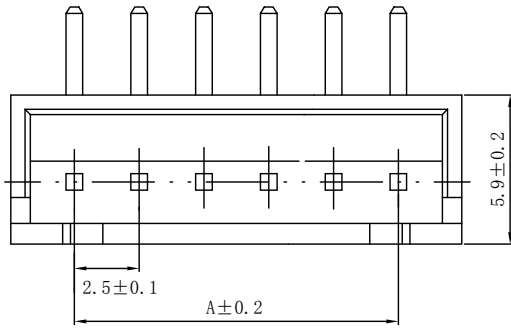
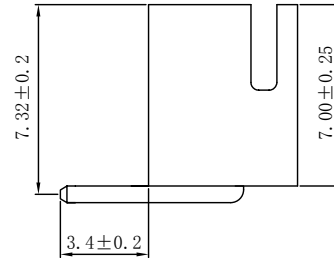
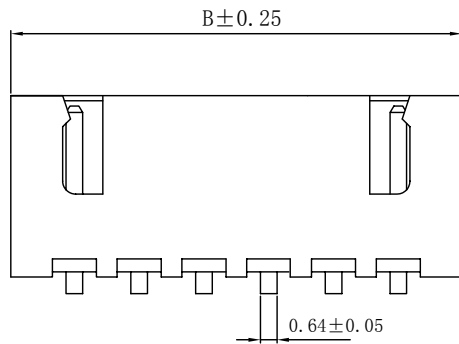

PCB LAYOUT

P数	尺寸 (mm)	
	A	B
2	2.5	7.5
3	5.0	10.0
4	7.5	12.5
5	10.0	15.0
6	12.5	17.5
7	15.0	20.0
8	17.5	22.5
9	20.0	25.0
10	22.5	27.5
11	25.0	30.0
12	27.5	32.5
13	30.0	35.0
14	32.5	37.5
15	35.0	40.0
16	37.5	42.5

一般公差 TOLERANCES		深圳市宏利电子有限公司 Shenzhen Holy Electronic Co.,Ltd	
X. ±0.40	.XX ±0.20	工程 图号	XH25-nAW
.X ±0.30	.XXX ±0.10	品名	XH2.5-nAW 弯针
ANGLES	±2°	TITLE	XH2.5mm Pitch AW DIP CONN
检验尺寸标示 SYMBOLS $\odot$ $\ominus$ INDICATE CLASSIFICATION DIMENSION	MARK IS CRITICAL DIM. MARK IS MAJOR DIM.	制图 (DR)	*10/03/22
表面处理 (FINISH)	比例 (SCALE)	单位 (UNITS)	核准 (CHKD)
1:1	mm	核准 (APPD)	Rigo Lu
张数 (SHEET)	SIZE	REV	
1 OF 1	A4	0	

修订 REV	修改摘要 REVISION DESCRIPTION	日期 DATE	签名 SIGNATURE
-	-	-	-